



TEMPERATURE METER FOR THERMOCOUPLES



96spDC

For measuring temperature with standard thermocouples (DIN IEC 584).

Technical data:

- Movement:** moving-coil with pivot and spring-type bearing.
- Instrument case:** steel-plate.
- Scale length:** 62 mm.
- Class of accuracy:** 1.5 (built in cold-junction compensation).
- Lead-wire resistance:** 0...100 Ω
- Supply:** 230 V -15...+10%, 50 Hz, max. 5 VA
- Working position:** horizontal (see Fig.1. 2/b).
- Weight:** approx. 0.5 kg.
- Fixing elements:** with two spring-type fastening clips (DIN 43835 "A")



Frame dimensions	96x48 mm	
Type	96 spDC	
Measuring range	Cat. No. 1620-27-...	Thermocouple type to use
0 ... 400 °C	002	J (Fe-CuNi)
0 ... 600 °C	003	J (Fe-CuNi)
0 ... 900 °C	004	J (Fe-CuNi)
0 ... 600 °C	005	K (NiCr-Ni)
0 ... 900 °C	006	K (NiCr-Ni)
0 ... 1200 °C	007	K (NiCr-Ni)
0 ... 1200 °C	008	S (PtRh-Pt)
0 ... 1600 °C	009	S (PtRh-Pt)

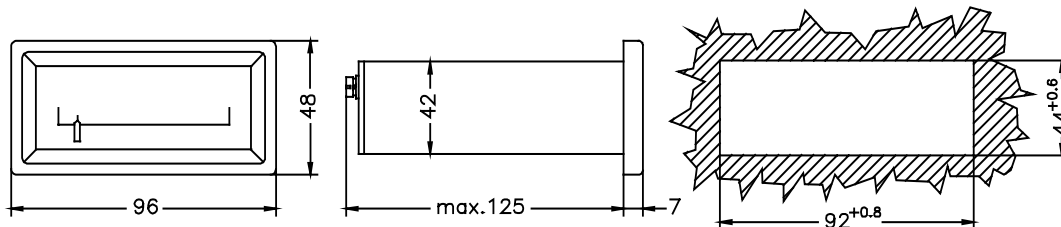

Scales (M=1:1)

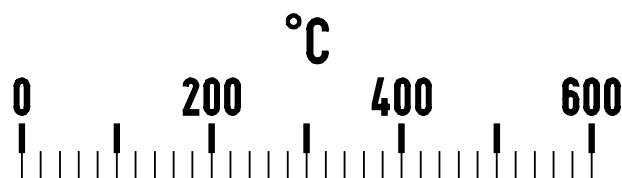

Order specification:

- Temperature meter for thermocouple
- Frame size: 96x48 mm
- Range: 0...900°C
- Thermocouple: K (NiCr-Ni)

Ordering data:

- Temperature meter for thermocouple
- Type: **96spDC**
- Cat. No.: **1620-27-006**



TEMPERATURE METER FOR THERMOCOUPLES



144spDC

For measuring temperature with standard thermocouples (DIN IEC 584).

Technical data:

- Movement:** Moving-coil movement with pivot and spring-type bearing.
- Instrument case:** steel-plate.
- Scale length:** 103 mm.
- Class of accuracy:** 1.
- Lead-wire resistance:** 20 Ω
- Input resistance:** 10 Ω /mV
- Working position:** horizontal (see Fig.1. 2/b).
- Weight:** approx. 1.2 kg.
- Fixing elements:** with two screw-type fastening clips (DIN 43835 "B")



Frame dimensions	144x72 mm	
Type	144 spDC	
Measuring range	Cat. No.	Thermocouple type to use
0 ... 200 °C	001	J (Fe-CuNi)
0 ... 400 °C	002	J (Fe-CuNi)
0 ... 600 °C	003	J (Fe-CuNi)
0 ... 900 °C	004	J (Fe-CuNi)
0 ... 600 °C	005	K (NiCr-Ni)
0 ... 900 °C	006	K (NiCr-Ni)
0 ... 1200 °C	007	K (NiCr-Ni)
0 ... 1200 °C	008	S (PtRh-Pt)
0 ... 1600 °C	009	S (PtRh-Pt)

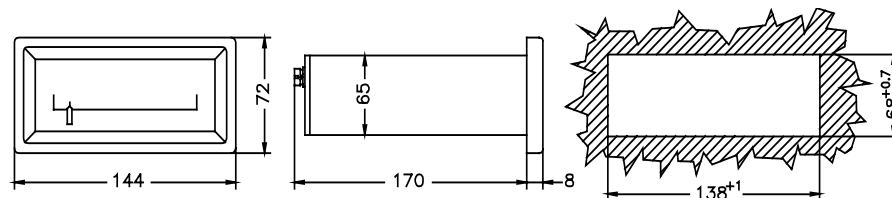

Scales (M=1:1)



Order specification:

- Temperature meter for thermocouple
- Frame size: 144x72 mm
- Range: 0...600 °C
- Thermocouple: J (Fe-CuNi)

Ordering data:

- Temperature meter for thermocouple
- Type: **144spDC**
- Cat. No.: **0503-27-003**

Note: On request -0...20 Ω lead-wire compensating resistor. Type: TRV-2 20 Ω